

← 5.64 m →

← 1.11 m → ← 1.02 m →

↑ 2.85 m ↓

↑ 1.47 m ↓

↑ 0.92 m ↓

↑ 2.54 m ↓

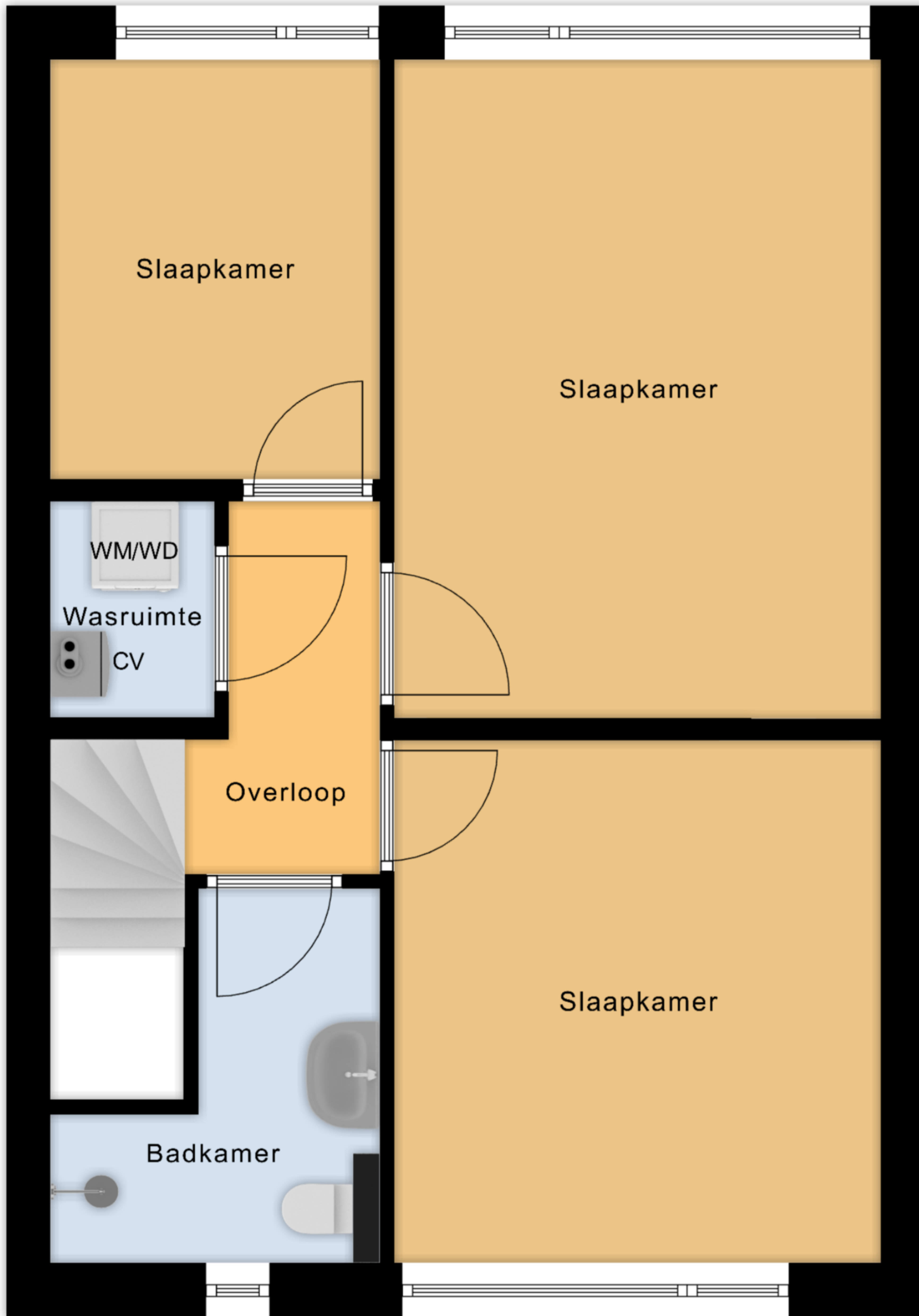

↑ 4.47 m ↓

↑ 8.17 m ↓

↑ 3.55 m ↓

← 2.23 m → ← 3.31 m →

1e Verdieping